

Carterton Residents' Guide

Helpful information for residents, in one place



Te Kaunihera-ā-Rohe o Taratahi
CARTERTON
DISTRICT COUNCIL

**Mai i te pae maunga, raro ki te tai
Mai i te awa tonga, raro ki te awa raki
Tēnei te hapori awahi ai e Taratahi.
Whano whano, haramai te toki
Haumi ē, hui ē, tāiki ē!**

From the peaks of our mountains,
down to the coast

From Waiohine to the South, down to
Waiawangawanga to the North

This is our community, embraced by
Taratahi .

It binds us and strengthens us.

We move forward together.

I sneeze! 'Tis the breath of life.



Contents

Nau mai, haere mai. This Residents' Guide is designed to help you easily find information about Carterton District Council's services, facilities, and community activities. Whether you're new to the district or a long-time resident, use this guide to understand how to access local services, stay up-to-date, and connect with your Council and community.

About Carterton | Mō Carterton

About Carterton and a short history	6
Welcome from the Mayor	8
Stay up to date	10

Council Services | Ngā Ratonga a te Kaunihera

Council Te Kaunihera	14
Community services Ngā Ratonga Hapori	20
• Neighbourhood Support	21
• Citizenship	21
• Mayors Taskforce for Jobs	22
• Grants and Funding	23
• Climate Change	24
• Emergency management	25
• Planning for an age-friendly Carterton	26
• Charles Rooking Carter awards	27
• Wairarapa Events Centre	28
• Carterton Library Te Whare Pukapuka o Taratahi	29
• Local events	30
• Youth Council	31
Parks and reserves Ngā Pāka me ngā Papa Rēhia	32
Building and planning Mahere me ngā ture whakahaere	38
Water and waste services Ngā ratonga wai me te para	42
Infrastructure – Ngā hanganga matua	46
Rubbish and recycling – Para me te ngā hangarua	48

About Carterton

Mō Carterton





Image credit: Carterton Historical Society, 2026

About Council and Carterton

Carterton District Council provides the everyday services and support that keep our community running smoothly. From clean water and safe roads, to parks, libraries, events, and planning, the Council’s role is to support residents, businesses, and visitors and together, make Carterton the best place it can be.

History of Council

Carterton District Council was formed in 1989 as part of New Zealand’s local government reforms, merging smaller borough and county councils into a single district council. Its predecessor, the Carterton Borough Council, had served the town since 1887, guiding local development for more than a century. Today, the Council continues to provide essential services, manage infrastructure, support environmental stewardship, and engage with the community, balancing Carterton’s rural and urban areas with modern governance.

Our commitment to Te Tiriti

Carterton District Council is committed to honouring Te Tiriti o Waitangi and partnering with iwi and hapū to guide decision-making and planning. We work closely with local hapū, including Hurunui-o-Rangi Marae and Ngāti Kahukuraawhitia, to embed Māori perspectives into Council projects, events, and community initiatives. Through these partnerships, te reo Māori, tikanga, and cultural heritage are increasing across the district, paving the way for Carterton to become more inclusive and reflective of its rich history and tangata whenua.

History of Carterton

Carterton sits in the heart of Wairarapa, with a vibrant community and a mix of rural and urban landscapes. Its history is shaped by both Māori and European settlement, with Hurunui-o-Rangi Marae and significant sites such as Te Uru o Tāne, the resting place of rangatira, Ngātuere Tāwhirimatea Tāwhao reflecting the deep connections tangata whenua have with the land. European settlers arrived in the mid-19th century, developing farming, trade, and local infrastructure, while the town grew as a hub for education, culture, and recreation. Today, Carterton celebrates this heritage while looking forward to a resilient future for all residents.



Image credit: Carterton Historical Society, 2026

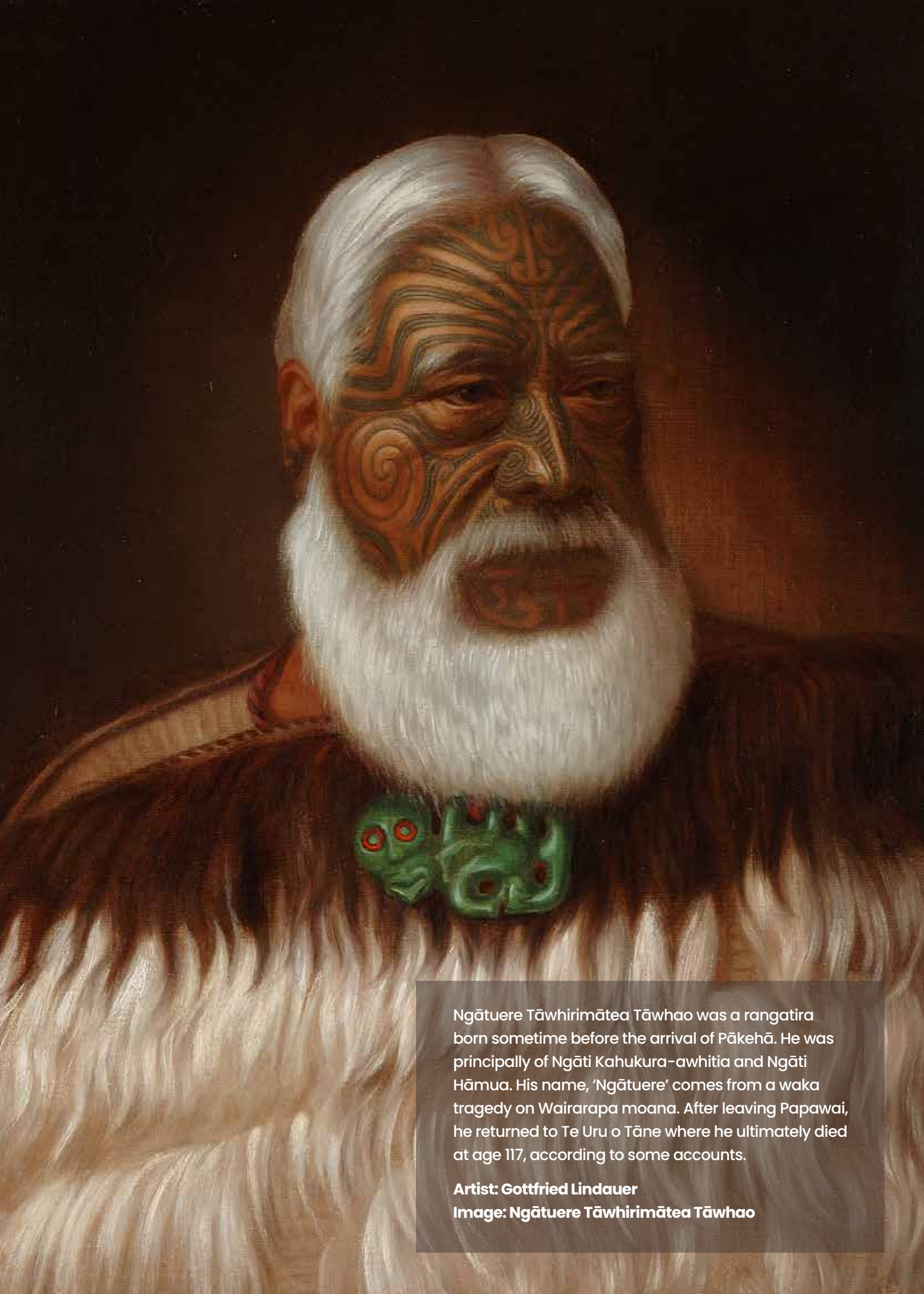

Ngātuere Tāwhirimātea Tāwhao was a rangatira born sometime before the arrival of Pākehā. He was principally of Ngāti Kahukura-awhitia and Ngāti Hāmua. His name, 'Ngātuere' comes from a waka tragedy on Wairarapa moana. After leaving Papawai, he returned to Te Uru o Tāne where he ultimately died at age 117, according to some accounts.

Artist: Gottfried Lindauer

Image: Ngātuere Tāwhirimātea Tāwhao

Welcome

From the Mayor of Carterton – Steve Cretney

Kia ora, nau mai, haere mai.

Welcome to the Carterton District Council Residents' Guide – your introduction to everything that makes our district a special place to live.

Carterton is a community at the heart of the Wairarapa. As the sun rises over the Maungarake Ranges and dusk paints the Tararuas in gold, Taratahi feels like a place where you truly belong, nestled beneath the vast canopy of the Wairarapa Dark Sky Reserve. Whether you're walking your dog at Sparks Park, chatting with locals at the Sunday Farmer's Market, strolling through Fensham Reserve, or cheering on sports teams at Howard Booth Park, you'll find connection and activity around every corner.

Our incredible district is home to an award-winning events centre that hosts a spectacular array of shows, functions, weddings, and expos. Alongside our historic library and several purpose-built meeting spaces, the Wairarapa Events Centre is a place that brings our community together.

Inside this guide, you'll discover practical information about our council services, from water, waste, and roading, to parks, our library, and recreation – alongside ways you can get involved in community life through our districts many voluntary organisations.

Whether you're new to Carterton or have lived here for many years, I hope this guide helps you find what you need and maybe even discover something new.

Nga mihi,

Steve Cretney
Mayor, Carterton District Council



2024/25 in numbers

119,491

Library print items issued and returned

8,330

Tickets sold at our Wairarapa Events Centre

214

Building consents issued

2,627

Dogs registered

226,480kg

Collected for general recycling

10,300

Residents

1,341

Local businesses

441km

Of roads. 296km sealed, 155km unsealed

48.4 years

Median age

Note: data taken from the 2024/25 financial year

Stay up to date

Where to find the latest, most up to date information:

Website – www.cdc.govt.nz

Your main source for official Council information, including services, meetings, decisions, consultations, and how to get in touch.

Facebook.com/[cartertondistrictcouncil](https://www.facebook.com/cartertondistrictcouncil)

Day to day updates such as road closures, maintenance, meetings, events, reminders, and community notices.

Instagram.com/[cartertondistrictcouncil](https://www.instagram.com/cartertondistrictcouncil)

A visual snapshot of life in Carterton, sharing community moments, events, and key messages.

YouTube.com/[@cartertondistrictcouncilnz852](https://www.youtube.com/@cartertondistrictcouncilnz852)

Recordings of public Council and community meetings, and campaign and project videos.

Podcasts

Hear updates from the Mayor and Council experts, covering meeting decisions and major projects.

Website



Facebook



Instagram



YouTube



TikTok - @cartertondistrictcouncil

Short, engaging videos that share Council and community updates in a youth-friendly way.

Pulse Surveys

Quick feedback surveys via QR codes at Council facilities to help improve the services you use.

Midweek and Carterton Crier

Council updates, reminders, and community notices shared through local print media.

Email newsletter

Quarterly Council updates delivered to your inbox, including consultations, water updates, and community news.

[LinkedIn.com/company/67392927](https://www.linkedin.com/company/67392927)

Professional updates about Council projects, organisational news, and career opportunities.

TikTok



Email newsletter



LinkedIn



Council Services

Ngā Ratonga a te Kaunihera





Council

Te Kaunihera



Customer services

**Nau mai, haere mai ki tō tātou
Carterton!**

**We're here to help keep Carterton
running smoothly, but some things
take teamwork between residents,
contractors, and the Council.
Understanding how services work
helps us all get the best results for
our community.**

Your property and ours

Council looks after public spaces, including some roads, urban berms, footpaths, streetlights, parks, and water services. Property owners are responsible for maintenance within their boundary, such as mowing, clearing private drains, or trimming hedges and trees that grow from their property onto footpaths.

How requests are managed

When you report an issue, it's logged in our system and passed to the right team at Council or contractor depending on the type of work required. Some repairs can be completed quickly, while others may need specialist parts, traffic management, or coordination with other projects and priorities.

Partnerships

Sometimes it's not clear who to contact when something needs attention. For example, noise complaints, boy racers, or abandoned vehicles on roads, which are handled by Police, while animal welfare concerns go to the SPCA.

Some roads, like State Highway 2 (SH2), are not managed by council. These are controlled by Waka Kotahi NZ Transport Agency (NZTA). This means requests such as adding a pedestrian crossing or changing speed limits, aren't decisions Council can make.

If you're unsure, get in touch with us, we'll point you in the right direction.

We appreciate your patience as we work through requests. Urgent safety issues are addressed first, and we'll always do our best to keep you informed along the way. Every request helps us plan maintenance better and keep Carterton a great place to live.

Ngā manaaki katoa



Contact

In person: we're based at 28 Holloway Street, Carterton and are always happy to help over the service desk.

Call: (06) 379 4030

Submit a service request by scanning the QR code, or visit our website.

Website: www.cdc.govt.nz



Council works for you

This section explains who is on Council, what Council does, how decisions are made, and how we engage with you to make sure you can have your say.

Council sets the strategic direction for the district, develops policies, and makes decisions that guide local growth and wellbeing. We also provide services, maintain infrastructure, and manage water, waste, and community resources to keep Carterton running smoothly.

Who is on Council?

Carterton District Council is made up of the Mayor and eight elected Councillors who represent you and make decisions about your community.

What does Council do?

Contact

For Councillors contact details, and to see their portfolios, visit our website by scanning the QR code.



2025 – 2028 Mayor and Councillors



Mayor Steve Cretney



Deputy Mayor Grace Ayling



Cr Jane Burns



Cr Simon Casey



Cr Brian Deller



Cr Steve Gallon



Cr Steve Laurence



Cr Lou Newman



Cr Rachel Round

How Council makes decisions

Council decisions follow a clear process to ensure transparency and fairness.



Public consultation

We want your input. Each year we send out surveys, consult on projects like the Speed Management Plan, or the water service delivery Local Water Done Well proposal, and invite feedback on annual or long-term plans. Your voice helps shape Council decisions, ensures our goals reflect community priorities, and keeps us accountable to meet the targets and commitments we set together. Keep an eye out on our key channels (ref page 10-11) where we ask for your engagement and consultation.

Attending meetings and public forums

Our community are welcome to attend Council and committee meetings, and advisory groups. Should you wish to speak, you can do so during public forum opportunities. You have up to five minutes to present your views on issues that matter to you – just contact Democratic Services at least two full days before the meeting to register and we'll ensure you're on the agenda to speak.

If you cannot attend in person, a videoconference link (Teams) is available on page 5 of the agenda.



Contact

YouTube: Scan the QR code to view recorded Council hui



Hui agendas: Scan the QR code to find the hui minutes and agendas

Email the Democratic Services team for any other information demservices@cdc.govt.nz



Rates

Your rates help fund the essential services and infrastructure that make Carterton a great place to live. Things like water, roads, parks, libraries, waste collection, animal control, and community facilities. Together, these services help keep our district well maintained.

Rates invoices are issued in quarterly instalments on:

- 20 August
- 20 November
- 20 February
- 20 May

We are working toward a more sustainable future and reducing the use of paper. If you would like to receive your rates information by email instead of by post, contact us at rates@cdc.govt.nz.

For more information on property valuations, rates, and rate rebates, scan the QR code below. If you can't find what you need, our team is happy to help.

Contact

Email us: rates@cdc.govt.nz

Visit: cdc.govt.nz/your-council/properties-and-rates



Community Services

Ngā Ratonga Hapori



Image credit: Jessie Carlson, 2025

Community services

The Community Services Group provides public places, facilities and services to make Carterton a welcoming and vibrant community where people enjoy living. It manages the Library, Events Centre, parks and reserves as well as community development activities including arts and culture, economic development, neighbourhood support, climate change action, community funding, community events, youth development and civic ceremonies.

Neighbourhood Support

Be part of a network that looks out for each other. Neighbourhood Support is a community-led network that helps neighbours stay connected, informed, and resilient. By joining, you become part of a district-wide effort to look out for one another, strengthen neighbourhood ties, and improve safety and wellbeing across Carterton. It's a simple way to stay prepared, share information, and build a stronger community together.

Join

Start a Neighbourhood Support group in your street and learn more by scanning the QR code, or call 06 379 4081 for more information.



Citizenship

Becoming a New Zealand citizen is a special milestone, and Carterton District Council is proud to host local citizenship ceremonies. These events welcome new citizens and celebrate their commitment to Aotearoa New Zealand.

The Mayor, or an official, leads the event, where new citizens taking the oath or affirmation, certificates are presented, and the national anthem is sung in te reo Māori and English. Families and friends are invited to celebrate alongside the new citizens.

Apply for citizenship through the Department of Internal Affairs. Invitations to local ceremonies are sent directly by the Department. Ceremonies are usually held several times a year at the Wairarapa Events Centre.

Contact

Scan the QR code or visit www.cdc.govt.nz for more information.

Call: 06 379 4030



Mayors Taskforce for Jobs

Mayors Taskforce for Jobs (MTFJ) Wairarapa's Community Employment Programme (CEP) connects local rangatahi (youth aged 16–24), with local business, and local success. MTFJ's mission is simple: to connect young jobseekers with real employment opportunities across Wairarapa.

MTFJ recognises that one size doesn't fit all, and the CEP clearly demonstrates what can be achieved in our communities when central and local government work in partnership alongside iwi, businesses and the community. Since 2020, MTFJ has helped thousands of young New Zealanders into sustainable work. The programme highlights the power of localism, promoting community-led solutions for youth employment, education, and training.

In Wairarapa alone, more than 100 young people have stepped into meaningful careers, strengthening our local economy and community.

MTFJ Wairarapa is a local partnership between the Carterton, Masterton, and South Wairarapa District Councils. Delivered under the national MTFJ programme, in partnership with Local Government New Zealand (LGNZ) and the Ministry of Social Development (MSD).

Contact

Scan the QR code or visit mtfjwairarapa.nz for more information.





Grants and funding

Carterton District Council is committed to supporting community led events that enhance the wellbeing, resilience, and vibrancy of our community. Funding is provided to support individuals, groups, and organisations who are working to deliver positive outcomes for the Carterton District.

Carterton District Council administers a variety of grants to support projects, events, and initiatives that benefit our community. Funding is available for arts, sport travel costs, environmental projects, waste minimisation, education, and more.

Grants and funds include:

- **Community Grants Fund** – local and regional initiatives.
- **Creative Communities Scheme** – support for arts projects that encourage participation, diversity, or youth engagement.

- **Sport NZ Rural Travel Fund** – helps rural sports clubs and school teams support with travel costs.
- **Waste Minimisation Grant** – supports innovative projects that reduce waste.
- **Carterton & Districts Returned & Services Memorial Trust Tertiary Grant** – provides a Tertiary fund for residents of the Carterton District who are direct descendants of veterans and servicemen.

Applications are made online via the Smarty Grants portal, with deadlines varying by fund.

Contact

Email: grants@cdc.govt.nz

Call: 06 379 4081

Scan the QR code to visit our website for more information.



Climate change

Carterton is committed to taking practical action on climate change, guided by our Climate Change Strategy. The strategy focuses on reducing emissions, building resilience to extreme weather, and supporting a sustainable and healthy district for all residents. By planning for the long term, we aim to ensure that Carterton remains a great place to live, work, and enjoy the natural environment.

Council's Climate Change work aims to drive meaningful action on climate change adaptation. As the climate changes, how well we adapt will be increasingly important. Carterton District Council plays an important role in our collective adaption efforts and supporting the community through change, as well as enabling sustainability organisations in our community that are making a difference.

One initiative that Council encourages the community to take part in is our ongoing conversations about climate and sustainability, held through monthly Climate

forums and workshops. These gatherings are welcoming and informal, giving residents, local businesses, and landowners the opportunity to explore a range of topics, share ideas, and contribute to local solutions. Past discussions have covered themes such as "thinking like a forest," freshwater challenges, energy use, and waste reduction.

Get involved: Residents can participate in future forums, learn from local experts, and bring their ideas to help shape how Carterton adapts to climate change.

Contact

Read the climate change strategy by scanning the QR code, or you can visit our website:

www.cdc.govt.nz



Emergency management

Emergencies can happen at any time; floods, earthquakes, storms, or fires can disrupt services. Being prepared helps you, your whānau, and your community stay safe and recover faster.

At home

Make a plan with your household, keep seven days' worth of food, water, and essentials, pack a grab bag, secure heavy furniture, and stay informed through local radio, social media, and Emergency Mobile Alerts.

Community emergency hub

If services are disrupted, the Wairarapa Events Centre on Holloway Street may be activated and become the Community Emergency Hub. It's a place to share information, ask for or offer help, and stay connected when phones or internet may be down. Strong neighbourhood connections make a real difference in emergencies.

Get involved

You can help by learning where the Hub is, bringing supplies, and volunteering your time. Roles include welcoming people, sharing information, and linking community needs with offers of help. Open to all ages and abilities, no experience needed! Building connections with your neighbours now makes your community stronger when it matters most.



Contact

Visit wremo.nz to learn more about how you can be prepared in the event of an emergency. Or scan the QR code to visit the CDC website.

You can also build connections by joining Neighbourhood Support



Planning for an age-friendly Carterton

The Wairarapa Positive Ageing Strategy provides direction for our district with a population that is rapidly growing older. In the next 25 years, the number of Wairarapa residents aged over 65 is projected to increase significantly, reaching nearly one in four people across the region.

The strategy's vision is to ensure older residents lead valued, connected, and fulfilling lives. It provides a shared framework that guides councils in improving and integrating services for older people, helping the region become more age friendly.

To achieve this, the strategy identifies six key focus areas shaped through extensive local consultation and research:

- Community support and health services
- Communication and engagement
- Transport
- Cultural diversity
- Housing
- Places, spaces, and activities

These priorities guide Council planning, service delivery, and community partnerships, ensuring that the needs of older people are considered across all areas of work. By aligning with this strategy, Carterton District Council continues to build a district where ageing is celebrated, participation at every age is supported, and older residents feel connected, respected, and included.

Contact

Read the full Ageing Strategy and learn about Over the Fence on our website by scanning the QR code.



Over the Fence

Over the Fence is a campaign that celebrates the wisdom, creativity, and lived experience of older people in our community. Too often, ageing is spoken about in terms of frailty. This initiative turns that narrative around, shining a light on the many skills, stories, and knowledge that older people share.

Connect with your neighbours today to find out what story lives over the fence.



Charles Rooking Carter Awards

Celebrating the people who make Carterton extraordinary.

The Charles Rooking Carter Community Awards are Carterton's premier celebration of community contribution and local pride. Held every two years, the awards recognise the individuals, groups, organisations, and businesses whose generosity, leadership, and community spirit help make Carterton a vibrant and connected place to live.

The categories are:

- **Community Spirit & Service Award** – Recognises businesses, individuals or groups who go above and beyond for Carterton, through volunteering, leadership, or acts of kindness that strengthen community connection and wellbeing.
- **Arts, Culture & Heritage Award** – Celebrates those enriching Carterton's creative and cultural life, through arts, music, storytelling, cultural events, or preserving our shared heritage and te ao Māori values.
- **Environment & Sustainability Award** – Honours those leading efforts to protect, enhance, or revitalise our natural environment, from conservation and waste reduction to climate action and sustainable living.
- **Health, Wellbeing & Active Recreation Award** – Recognises businesses, initiatives or individuals improving physical, mental, or social wellbeing, including contributions

to sport, fitness, recreation, and community health.

- **Youth & Future Leaders Award** – Celebrates rangatahi and emerging changemakers (individuals or groups) who show leadership, creativity, and commitment to making a positive difference in their community.
- **Long Service Award** – Recognises an individual who has shown outstanding dedication and commitment to serving the Carterton community over many years. Their consistent contribution, loyalty, and selfless service have made a lasting difference to a local organisation, club, or cause.
- **Supreme Winner** – This award recognises the individual, group, or organisation whose contribution to the Carterton community stands out above all others. The Supreme Winner demonstrates exceptional impact, leadership, and dedication, making a significant and lasting difference to the wellbeing, culture, or spirit of the community.

Contact

Scan the QR code to visit our website and find out how you can nominate a Carterton champion.

www.cdc.govt.nz



Wairarapa Events Centre

The Wairarapa Events Centre is a lively community hub where people come together to celebrate, learn, and enjoy great experiences. It hosts a mix of events throughout the year, from concerts and theatre shows to workshops, weddings, exhibitions, and local gatherings.

Alongside the main Taratahi Auditorium and Te Mahou Foyer, the Centre also offers a range of meeting rooms and flexible spaces that can be booked for community events, business meetings, and private functions.

Whether you're attending a show, hosting a gathering, or hiring a space, the Events Centre team is here to help make your event memorable.



Contact

Website: wairarapaec.co.nz



Sign up to our mailing list by scanning the QR code



Book a venue by scanning the QR code



Facebook: follow us by scanning the QR code:



Library | Te Whare Pukapuka o Taratahi

The library is one of Carterton's most loved community spaces (according to our Community Survey!), offering a wide range of books and magazines, along with access to newspapers, printing, computers, and Wi-Fi. The library also provides free 24/7 digital access to ebooks, emagazines, audiobooks, movies, and documentaries.

You'll also find story time for tamariki, school holiday activities, book clubs, author talks, and digital skills sessions. The library holds local history, genealogy, and te ao Māori resources and has a friendly team ready to help.

Established in 1874, Carterton Library is one of New Zealand's oldest public libraries. The current library on Holloway Street was redesigned in 2010 to reflect Carterton's growing population and provide a welcoming community hub.

Open hours:

Monday – Friday: 9.30am – 5pm

Saturday: 9.30am – 1pm

Sunday & Public Holidays: Closed



Contact

Website: Scan QR code or visit cartertonlibrary.spydus.co.nz

Email: library@cdc.govt.nz

Call: 06 379 4080

Facebook: Scan QR code



TE WHARE PUKAPUKA O TARATAHI
CARTERTON LIBRARY

Local Events

Carterton loves a good celebration, and our events bring people together to enjoy everything our district has to offer.

Holloway Hoopla

Held every year, the Holloway Hoopla is a lively, family-fun event featuring games, crafts, grand entertainment, and community activities.

Carterton Daffodil Festival – Wairarapa Spring Day Out

Our iconic annual Daffodil Festival is a highlight of the year, celebrating spring with flowers, markets, and community fun.

Bring the family, catch a free bus to the historic Middle Run Farm and collect a bunch of daffodils. While you're in Carterton pick up a bargain at the High Street markets, watch street performers, enjoy music, dance, and live acts throughout the day and much more. You can also experience riding on a heritage passenger train trip from Carterton to Masterton and return.



Carterton
Daffodil Festival

Contact

Daffodil Festival website: Scan the QR code

Holloway Hoopla website: Scan the QR code



Youth Council

The Wairarapa Rangatahi Strategy (Te Rautaki Rangatahi o Wairarapa) is a combined regional strategy adopted by the Masterton, Carterton, and South Wairarapa District Councils to ensure rangatahi voices are central in council decision making and future planning.

The strategy outlines priorities identified by young people across the region and sets actions that support their wellbeing, identity, participation, and opportunities to thrive.

One of these key actions is strengthening youth participation through initiatives such as the Carterton Youth Council.

The Carterton Youth Council gives rangatahi a meaningful voice in shaping their community, offering opportunities to contribute to local projects, learn about democracy, plan youth focused events, and help Council understand what matters most to young people.

This ensures that the aspirations of rangatahi are reflected in local decision making and that young people are active partners in building a vibrant, future focused Wairarapa.



Contact

Facebook: follow us by scanning the QR code:



Youth Council website

Read the Wairarapa Rangatahi Strategy here





Parks and Reserves

Ngā Pāka me ngā Papa Rēhia

Parks and reserves

Carterton is full of green spaces, walking tracks, sports fields, playgrounds, picnic areas, and bush walks. There’s something for everyone to explore and enjoy.

Carrington Park

Our largest community park offers a playground, a skate park, basketball court, fitness equipment, a sealed walking track, StoryWalk®, free barbecues, and open fields for sport and community events.

Howard Booth Park

A local favourite for sport. Howard Booth Park is home to the football and squash clubs. The park features a lime walking track around the football fields, a playground for kids, and plenty of space for dogs to run.



Sparks Park

A favourite spot for local dog owners, Sparks Park offers a gentle loop walk surrounded by trees and native bush. Wander around the pond, meet other walkers along the way, and make use of the convenient dog wash station before heading home.

Bird’s Park

Bird’s Park is a compact neighbourhood park offering green space, playgrounds, and pump tracks for younger adventurers.

Millennium Park & Memorial Square

Central spaces perfect for relaxing, reflecting, or attending the Sunday market.

South End Park

Located halfway down South End Park on Brooklyn Road, offers an off-road wheels tracks and play equipment in a 0.45 hectare green space close to home for many residents. Pop along with your bike, take a picnic, or enjoy the swings.



Fensham Reserve

Native bush and a great walking track with a view over Carterton at the top, Fensham Reserve is ideal for a bit of exercise, birdwatching, and getting out for some fresh nature air.

Carters Reserve

Nestled alongside the Ruamahanga River in the Gladstone District, this reserve is a rare mix of grassland, wetland, shrubland and lowland forest.

Ngā Tawhai Reserve

A place of deep cultural and natural significance in rural Te Wharau, Ngā Tawhai Reserve is home to an ancient pā site and rare grassland, wetland, and forest habitats. A recently unveiled tomokanga (carved gateway) honours the reserve's whakapapa and local identity.

Moreton Reserve

A small, grassy reserve perfect for a picnic, a game of catch, or just relaxing outdoors.

Mount Holdsworth

Located at the eastern end of the Tararua Range, Mount Holdsworth offers a range of walking and tramping options, from the well-formed Gentle Annie Track to more challenging routes for experienced trampers. It's a popular day trip with access to native bush and alpine scenery, and a gateway into

the Tararua Forest Park.

Waiohine Gorge

Waiohine Gorge is a popular camping and recreation area; its also the south eastern entrance to the Tararua Forest Park. A long swing bridge spans the gorge, inviting you to venture into the forest. Several excellent walking adventures begin here, including the track to Cone Hut.

Mount Dick

Rising 520m above sea level, Mount Dick offers panoramic views over the Wairarapa plains and beyond. It's a popular spot for walkers and mountain bikers, with easy access from Kaipātangata Road at the end of Dalefield Road.

Kourarau Dam

A popular spot for fishing, Kourarau Dam is home to rainbow trout and perch. The lake provides a peaceful setting for anglers and visitors looking to enjoy the outdoors.

Flatpoint Beach

Explore the Wairarapa coast for fishing, diving, or a family day by the sea. The beach features a mix of sand and pebbles, perfect for picnics and coastal walks.

Contact

For maps, booking details, or to explore all parks and open spaces, visit





Clareville Cemetery – Urupā o Clareville

Carterton’s principal cemetery has served the district since the 19th century. This peaceful place for remembrance is open daily from dawn to dusk, with Council assistance available Monday to Friday, 9am–4:30pm. Burial and ash plots can be purchased through Council.

Please help us keep the cemetery peaceful for all visitors, take litter with you, and keep dogs on a leash at all times. Avoid driving or parking on grassed areas, and respect headstones and planted areas.

Berms & tree maintenance

Council maintains public berms and street trees. Residents are encouraged to keep berms tidy and mow grass where possible. For tree pruning or concerns, contact us. Please avoid parking on grassed berms to prevent damage.

No-Mow meadow initiative

Certain areas in our parks and reserves are left unmown to support local biodiversity, providing habitats for pollinators and native species. Residents are encouraged to respect these areas and allow the grass to grow naturally.

Contact

Email: info@cdc.govt.nz

Call: (06) 379 4030

Website: cdc.govt.nz



Carterton Outdoor Pools
127 Pembroke Street, Carterton

A FREE summer facility for the whole whānau, open from around December to March.

Including:

- > Toddler's pool with shade sail
- > Learners' pool with slide
- > Main pool with accessibility ramp, lane swimming and another larger slide

There are changing rooms, undercover seating, and picnic tables to enjoy in between swims and a great chance for child minders to relax and watch while staying dry.

The outdoor pool is connected to the indoor pool, however they are separate entities.

Contact

For current pool hours and information, visit our website by scanning the QR code.





Building and Planning

Mahere me ngā Ture Whakahaere



Building and planning

Our Building team checks that new builds and renovations meet national standards and support sustainable development in the district. If you're planning any building work, big or small, our team can guide you on what approvals you may need before you start.

Do I need consent?

Most building work requires a building consent from Council, confirming your plans meet the Building Code for structure, plumbing, drainage, and safety. Some smaller jobs are exempt, and you can check the full list of exemptions on the Ministry of Business, Innovation and Employment website. If in doubt, just reach out and ask our friendly team.

Even if your work is exempt, it must still meet the Building Code and may still require planning approval.

Building vs Resource Consent

- Building consent covers how something is built.
- Resource consent covers where, what and how your projects fits within the District Plan.

You may need a resource consent for Wairarapa things like:

- Building too close to a boundary
- Adding an extra dwelling
- Subdivision

You may even need both depending on your project. It's best to check before starting.

The District Plan

The Wairarapa Combined District Plan sets the rules for land use, development, noise, heritage, subdivision, and more. It helps protect what makes Carterton special while allowing for growth and it aligns us with the rest of the Wairarapa region.

If you want to:

- build or extend a house
- put up a new shed
- run a home business
- subdivide your property
- remove or trim a protected tree
- change land use

...our planning team can advise whether your project is permitted or needs consent.

You can view the District Plan at cdc.govt.nz/services/planning or visit us at Council.

Applying for consent

You can apply for a building consent online through the Objective Build Portal (build.objective.com) or pick up a form from our office. Make sure your application includes completed forms, plans, specifications, and relevant product and site information.

Need help with the portal? Call 0800 024 508 or email build.support@objective.com.

Resource consent applications can be emailed to planning@cdc.govt.nz

Contact

You can view the District Plan at: cdc.govt.nz/services/planning

Or scan the QR code:



Granny Flats (small standalone dwellings)

National regulations now allow some small standalone dwellings (also known as granny flats) to be built without a building consent, provided they meet strict criteria.

Before starting any work, you'll need to check that your project meets all requirements under the Building Act, the National Environmental Standard for Detached Minor Residential Units (NES DMRU), and the Wairarapa Combined District Plan. These rules cover building size, setbacks, natural hazards, services, and where granny flats are permitted within Carterton.

If your project qualifies for the exemption, you'll still need to apply for a Project Information Memorandum (PIM) before building. A licensed building practitioner is the best person to help you understand your obligations.

If your dwelling doesn't meet the exemption criteria, or if you purchase a pre built unit before applying for a PIM, you'll need to go through the standard building consent process.

Please note, Council does not check the plans submitted for Building Code compliance, we will not undertake inspections during work, and we do not issue any certification on completion of work. Council are simply a record keeper.

Contact

For full guidance, scan the QR code.

Alternatively you can contact consentsystem@mbie.govt.nz



Timeframes and costs

By law, Council has 20 working days to process building consents and resource consents, though this can be longer if more information is needed.

Contact

Fees and charges are available at cdc.govt.nz/your-council/fees

Or scan the QR code:



Call: 06 379 4030

Email: buildingadmin@cdc.govt.nz

Email: planning@cdc.govt.nz

Visit: cdc.govt.nz/services/building

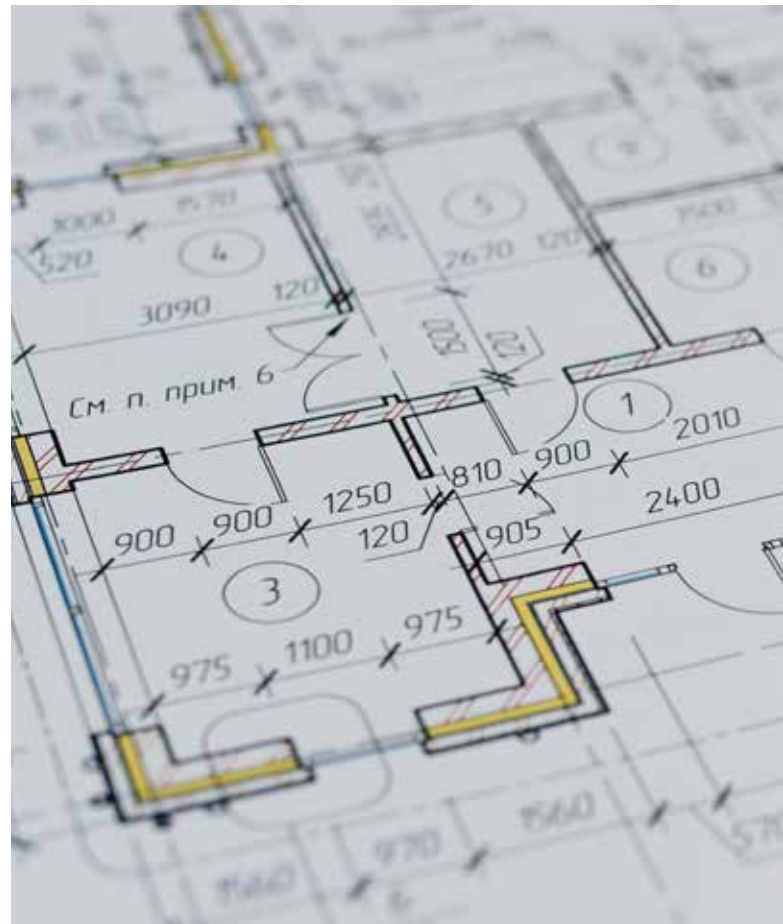

Noise control

Respect your neighbours. Everyone's entitled to make a bit of noise, but it shouldn't stop others from enjoying their homes either. If things get too loud, you have the right to have excessive noise reduced or stopped.

You can report noise at any time. If the noise is happening during business hours, call our friendly team at Council and we'll do our best to resolve it quickly. After hours, you can call our 24/7 line.

We work with contractors to respond to complaints, but please only call if the noise is genuinely excessive. Call-out fees can be charged back to ratepayers if the noise is not considered excessive.

A little consideration goes a long way. If you're planning something noisy, give your neighbours a heads-up in advance.

Contact

During business hours: 06 379 4030.

After hours Noise Control: 0800 664 732

Or scan the QR code:



Water and Waste Services

Ngā Ratonga Wai me te Para



Water services

Council provides safe, reliable drinking water and waste water to Carterton. Water is essential for health, growth, and our environment, and it's everyone's responsibility to use it wisely.

Drinking water

Our urban water comes from the Kaipaitangata Stream and two underground bores. Daily water collection and treatment depend on rainfall, and recent upgrades have increased storage by 4 million litres to better meet demand.

Water restrictions may be applied in hot, dry periods to conserve supply for all users, including firefighting, and to protect the environment. Check our website, the High Street water restriction billboard, Facebook page, or local media to see if restrictions are in place.

Metered water:

Residential users have an annual allowance of 225 cubic metres. Any usage above this is charged per cubic metre. You can monitor your use via your water meter to avoid unexpected bills. Check your meter regularly and report leaks promptly.

About your water meter:
Scan the QR code to visit our website



Handy information

General water services



Check your daily water usage



Water Restrictions



Simple ways to save water:

- Collect rainwater to use over the drier months or store for an emergency (you can purchase heavily subsidised tanks from Council)
- Shorten showers by a minute or two – every drop counts
- Turn taps off while brushing teeth
- Run washing machines only with full loads
- Mulch your garden to reduce evaporation
- Soak plants less often but more deeply

Wastewater

Wastewater from homes and businesses is treated at our Dalefield Road treatment plant before being returned safely to the environment. Council is responsible for treatment, but you are responsible for pipes and blockages inside your property. We ask residents to be careful about what is being flushed down the toilet – you'd be surprised at what we find (batman costumes – yes that happened!, towelettes, lipsticks... and more). This all costs to fix. Please do not flush anything that isn't meant to go into the toilet.

Council works closely with the community and partners like the Mangatāre Restoration Society to protect waterways and explore sustainable wastewater solutions.

Stormwater

Stormwater drains rain from streets, gardens, and roofs to prevent flooding and protect waterways. Council manages the network, but residents can help by keeping drains clear and avoiding dumping garden waste or chemicals into the system.

Water saving tips: Scan the QR code to visit our website:

www.cdc.govt.nz



Contact

Call: 06 379 4030

Email: info@cdc.govt.nz





Infrastructure

Ngā Hanganga Matua



Infrastructure services

Our Infrastructure team keeps Carterton's roads and transport networks reliable and well maintained. From potholes to road closures, here's how it all works and how you can help keep things moving smoothly.

Roads in Carterton

Council maintains around 441 kilometres of local roads, of which 286km are sealed and 155km unsealed. Most roads across the district are managed by Council, while State Highway 2 (High Street) is managed by Waka Kotahi NZ Transport Agency (NZTA).

If you're planning work that affects a public road, like digging, installing services, or hosting an event, you'll need permission first.

You may need to contact Council for:

- New driveways or accessways
- Temporary road closures for events
- Excavation or utility work
- Roadside activities like hedge trimming or maintenance

Common road issues

We're out regularly inspecting and maintaining roads, but sometimes things pop up between checks. You can help by reporting the following through a service request:

- Potholes or surface damage
- Blocked drains
- Damaged signage or road markings
- Fallen trees or debris

Please note we do our best to fix issues as fast as we can. Sometimes we work with third party experts and it may take a little longer than we anticipate. We appreciate your patience as we work through these.

Who is responsible?

Council looks after:

- Local roads and footpaths
- Streetlights (except State Highway 2)
- Drains and culverts on local roads

Waka Kotahi (NZTA) looks after:

- State Highway 2 (High Street)
- Major intersections and bridges along SH2

If you're unsure who to contact, reach out to us first, we'll point you in the right direction if we can't help.

Contact

Learn more: beforeudig.co.nz or call 0800 248 344

You can submit a service request to info@cdc.govt.nz/service request

Or scan QR code to visit our website.

www.cdc.govt.nz



Rubbish and recycling

Carterton has a weekly kerbside collection service to help keep our community clean and waste out of landfill. Please note that collection times can vary depending on the route and load. Our team has until 7pm to complete collections, so don't panic if yours hasn't been picked up at the same time every week. If it's still full the following morning, contact us and we'll help sort it out.

Rubbish Collection

Rubbish is collected every Monday (or Tuesday if there's a public holiday on Monday).

You can:

- Use official Carterton rubbish bags – available from local supermarkets, dairies, petrol stations, and the Council office.
- Arrange your own private rubbish bin service through providers like WaiBins or Low Cost Bins.

Place your rubbish out by 7.30am on collection day. If it's not out, it won't be collected until the following scheduled collection day.

Recycling collection

Recycling is picked up every Monday, alternating between Week 1 and Week 2 collections:

- Week 1: Your recycling wheelie bin (black bin with a yellow lid) – for clean tins, cans,

paper, cardboard, and plastic bottles or containers numbered 1, 2, or 5.

- Week 2: Your glass crates (green and maroon) is for glass bottles and jars only (remove lids)

You can check which week you're on at cdc.govt.nz and by looking for the number (1 or 2) on the sticker on your bin.

Soft plastics

Soft plastics, like bread bags, chip packets, and frozen food bags can't go in your kerbside recycling.

You can drop these off at the Carterton Transfer Station, or in the soft plastics bin at New World Carterton.

We also encourage households and businesses to set up their own soft plastics collection bin, and take directly to your soft plastic recycling bin at our Waste Transfer Station.



Binfluencer

Do you find yourself scrambling to remember which is the right bin to put out each week? We bet your neighbours do too. Lead the charge and join our Binfluencer email list for weekly reminders and relevant waste news.

Sign up

Scan the QR code to sign up or visit our website for further details:

www.cdc.govt.nz



Transfer Station

The Carterton Transfer Station on Dalefield Road is open to residents for disposing of general waste, green waste, scrap metal, soft plastics and recyclables.

It's also where you can take large items or anything that doesn't fit in your weekly collection.

Open hours:

Monday: CLOSED

Tuesday – Friday: 9am – 11am

Saturday: 9am – 12pm

Sunday: 11am – 4.30pm

Closed; Good Friday, ANZAC Day, Christmas Day, New Years Day

Please secure your load and drive carefully when entering or exiting the site.

Fee's and charges for this service can be found at www.cdc.govt.nz.



Which Bin This Week?

Please have your bins ready by 7.30am, Monday

Wheellie Bins

If your bin has a 2 sticker – put it out on Monday.



Crates

If your bin has a 1 sticker – put your crates out on Monday.



Mā te whakapono

Mā te tūmanako

Mā te titiro

Mā te whakarongo

Mā te mahi tahi

Mā te whakamomori

Mā te aroha

Ka taea e mātou

By believing and trusting

By having faith

By looking and searching

By listening and hearing

By working and striving together

By sheer desire and determination

By all being done with love

We will succeed





Te Kaunihera-ā-Rohe o Taratahi

CARTERTON
DISTRICT COUNCIL